

43-990 BIDET

Installation Instructions

Deck-Mounted Bidet Fitting

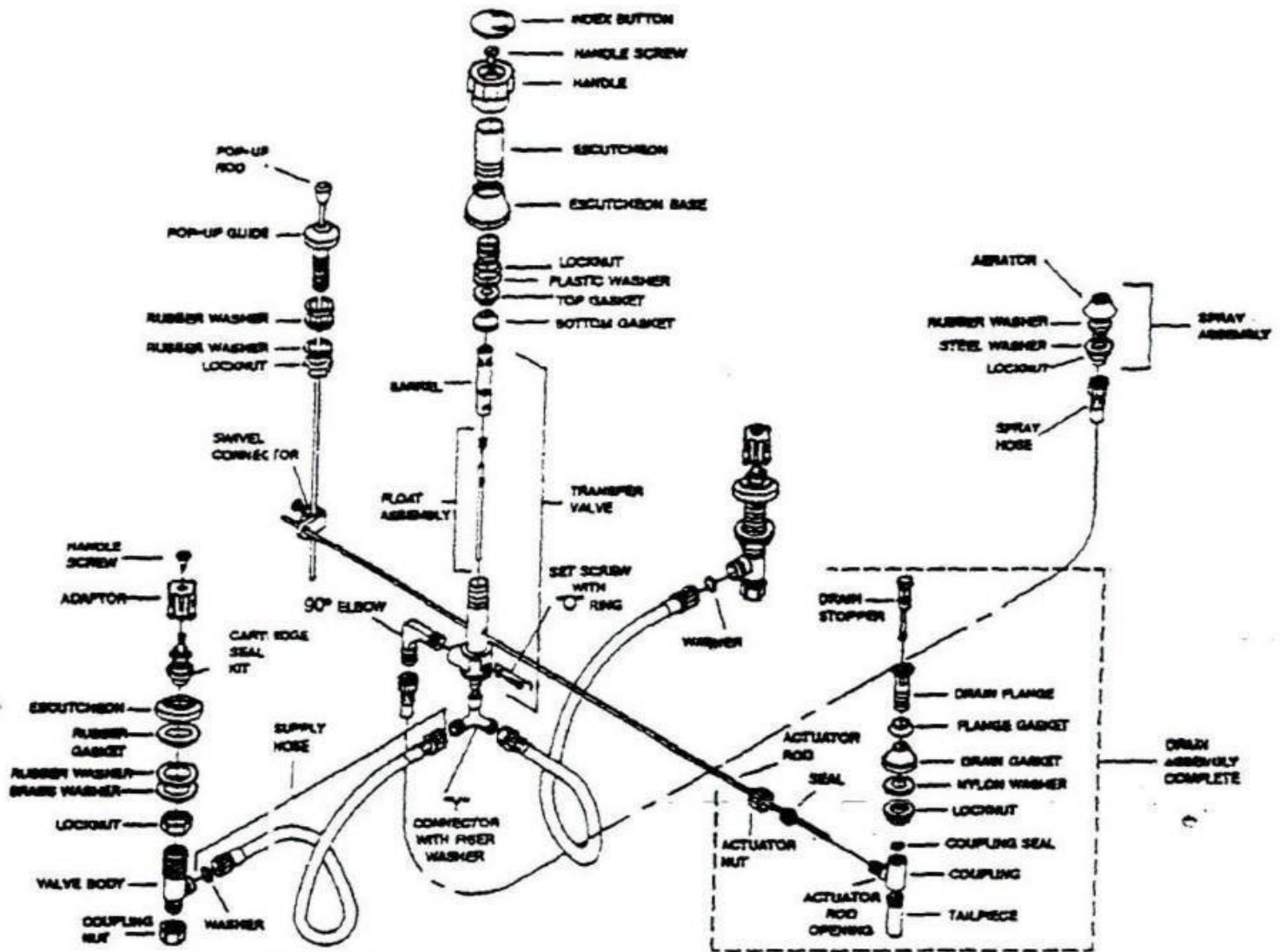

Figure 1

1 VALVE INSTALLATION

CAUTION: Turn off hot and cold water supplies before beginning.

Note: Steps 1 through 6 may be done before installing the bidet fixture.

Clean and dry the sink deck mounting surface.

Remove the top locknuts, brass, and rubber washers from the valves and spout body.

Insert the valve body subassemblies through the mounting holes.

On the valve bodies, finger-tighten the top locknuts down until the washer hits the larger diameter of the valve body.

Orient valves so that the side outlets are directed partially towards the rear center. Hand-tighten the bottom locknut to allow for final alignment of valves.

Add escutcheons and handles after final tightening of the valve bodies. See step 7.

Tighten the escutcheons by hand. If you have to hold onto the valve underbody, retighten the locknuts. Do not use toothed tools on the escutcheons while tightening.

2 Vacuum Breaker/Transfer Valve Installation

Remove handle screw, locknut, plastic washer, and top gasket.

Screw 90 degree elbow in side outlet of the transfer valve subassembly.

Screw "Y" connector in bottom outlet of the transfer valve.

NOTE: Use Teflon tape on threaded connections to prevent leakage.

Insert transfer valve subassembly through the forward center hole from the underside of the bidet fixture for orientation.

Replace top gasket, plastic washer, and locknut. Orient transfer valve so that the 90 degree elbow is directed to the rear of the fixture. Hand-tighten locknut to permit final alignment of valve.

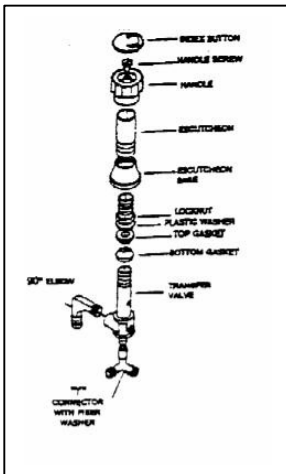

4 Spray Installation

Remove locknut, steel washer, and rubber washer from spray assembly. Apply putty to underside of escutcheon and drop into the smaller hole in front of the bowl.

Reassemble rubber washer and steel washer and tighten locknut to spray assembly from the underside of fixture.

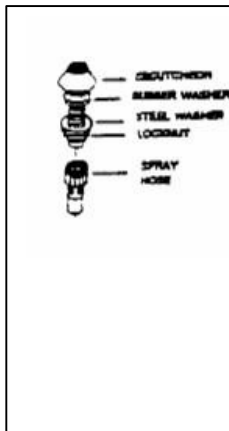

6 Hose Connections (see figure 1)

Firmly connect coupling nut of the plastic hose to spray body.

Firmly connect the coupling nut on the other end of the same hose to the 90 degree elbow connected to the transfer valve.

Connect large coupling nut of the plastic hose to the side outlet of each valve body subassembly (hot and cold). Insure the rubber washer is placed between valve port and hose.

Connect small coupling nut of plastic hose to the "Y" connector (hot and cold). Check all hose connections and firmly tighten. NOTE: Hoses are designed with in-line "O" rings. Just a twist and you have a water-tight seal. No tools required.

3 Drain Installation:

Clean and dry all mounting surfaces.

Remove the top flange and rubber washer.

Loosen the nut, follower, and mac washer to the lowest position of the drain assembly.

Insert the drain assembly through the underside of the sink. Apply sealant to the contact surface between the top rubber washer and the upper sink. (**Do not obstruct the overflow drain with sealant.**)

Reinstall rubber washer and flange to the drain assembly.

Tighten the lower nut, follower, and mac washer against the underside of the sink. Position the side port of the drain body to the back.

Do not over tighten the nut, washer, and mac washer!

Over-tightening may damage the seals or lavatory!

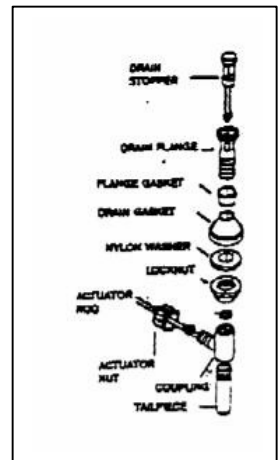

5 Pop-Up Glide Installation

Remove locknut and rubber washer from the pop-up guide. Insert guide through the hole of the bidet ledge.

Replace rubber washer and locknut. Hand-tighten locknut to the guide from the underside of fixture.

NOTE: Swing transfer to either side of guide while installing locknut. After tightening locknut, swing the transfer valve back to the original direction. Transfer valve is now in position. Firmly tighten locknut on transfer valve on top side of the fixture.

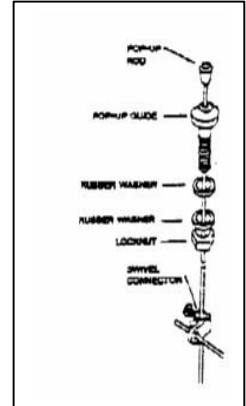

7 Finishing Installation (see figure 1)

Direct hot and cold valve towards 90 degree elbow, and tighten bottom locknuts firmly.

Drop pop-up rod through the guide. Insert actuator rod through the extension strap. Assemble pop-up rod through opening of extension strap and add clip over actuator rod. Adjust lift rod stroke for proper opening and closing of stopper by sliding pop-up rod in the extension strap.

NOTE: a) With the rod down, the stopper must be fully open.

b) With the lift rod up, the stopper must be fully closed.

Assemble transfer valve escutcheon subassembly by screwing base of escutcheon to locknut of transfer valve.

Push handle on the stem of transfer valve, and secure with handle screw. Assemble button into handle.

Connect the hot water supply to the left valve and the cold water supply to the right valve using the appropriate connectors and coupling nuts.

Turn the hot valve stem clockwise until it is in the off position and turn the cold valve stem counter clockwise until it is in the off position.

Push handles onto the stems and secure with handle screw. Assemble each handle with its appropriate index button. Turn on water supplies. Operate supply valves and transfer valve to check operation and check for leaks.